



Compression & Relief Valves (Manual)

Manual valves designed to relieve pressure, sample, or shut off flow

Types

- Shut Off (L-Body, Y-Body)
- Relief (L-Body)
- Sample

Seat Materials

- Molded Rubber (BUNA, EPDM, SFY)
- Metal (Not Available for Sample Valves)

End Connections

- Tri-Clamp®

Sizes

- Shut-Off/Relief (1" - 3")
- Sample (1 ½" - 3")

Valve Body Material

- 316L S.S.





Compression Valves (Y-Type)

D60YRMP-Size, Molded Rubber Seat
D60YMMP-Size, Metal Seat

Size (Tube OD)		A		B				Approx. Wt.	
				Min.		Max.			
in	mm	in	mm	in	mm	in	mm	lb	kg
1	25.4	5⅜	136.5	5¾	146.1	6⅜	161.9	2.25	1.02
1½	38.1	6⅜	161.9	8	203.2	9⅝	244.5	6.30	2.86
2	50.8	7⅞	200.0	8¾	222.3	11	279.4	9.90	4.49
2½	63.5	9¼	235.0	10⅜	263.5	13½	342.9	18.0	8.16
3	76.2	10⅜	263.5	12½	317.5	16⅜	415.9	26.1	11.8

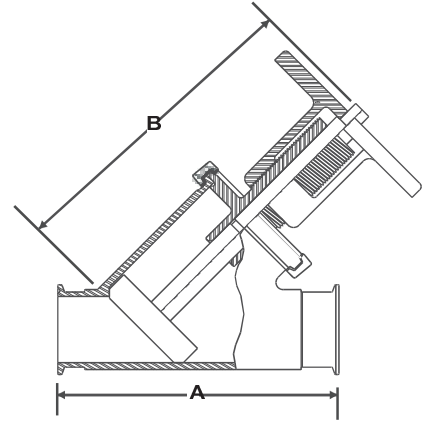

Material: 316L Stainless Steel
End Connection: Tri-Clamp®

Sample Cocks

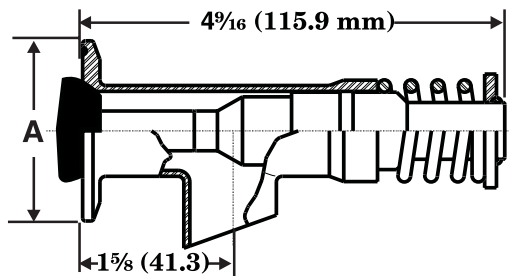

Tri-Clamp®

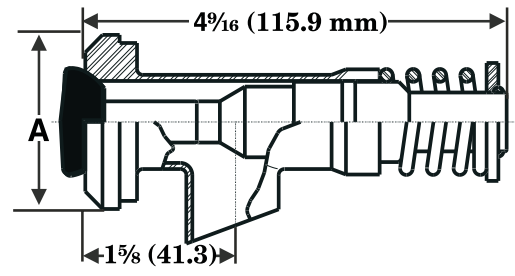

Bevel Seat

Type-Size

Size (Tube OD)		A306MP Tri-Clamp A		A306A Bevel Seat A		Approx. Wt.	
		in	mm	in	mm		
1 $\frac{1}{2}$	38.1	2	50.8	1 $\frac{7}{8}$	47.6	1.00	0.45
2	50.8	2 $\frac{1}{2}$	63.5	2 $\frac{3}{8}$	60.3	1.06	0.48
3	76.2	3 $\frac{1}{2}$	88.9	--	--	--	--

Material: 316L Stainless Steel

All dimensions are for identification purposes only.